

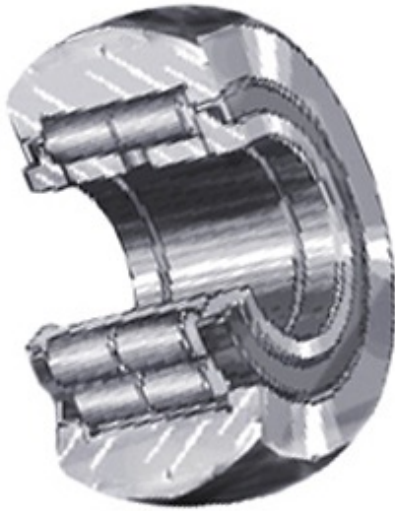

# GARLOCK BEARINGS LTD

## CONSOLIDATED BEARING NUTR-50 Cam Follower and Track Roller - Yoke Type



NUTR-50 Bearing 2D drawings and 3D CAD models

Bearing No. NUTR-50

Category	Cam Follower and Track Roller - Yoke Type
Inventory	0.0
Manufacturer Name	CONSOLIDATED BEARING
Minimum Buy Quantity	N/A
Weight	0.988
EAN	0644075080545
Product Group	B04144
Roller Surface Profile	Crowned
Profile	Yoke Type
Enclosure	Sealed
Rolling Element	Cylindrical Roller Bearing - Double Row
Relubricatable	Yes
Inch - Metric	Metric
Other Features	Full Complement
Long Description	50MM Bore; 90MM Roller Diameter; 30MM Roller Width; Crowned Roller; Yoke Type; Sealed; Cylindrical Roller Bearing - Double Row; Relubricatable
Category	Cam Followers Yoke Type
UNSPSC	31171530
Harmonized Tariff Code	8482.50.00.00
Noun	Bearing
Keyword String	Cam Follower



## GARLOCK BEARINGS LTD

Manufacturer URL	<a href="http://www.consbrgs.com">http://www.consbrgs.com</a>
Manufacturer Item Number	NUTR-50
Weight / LBS	2.18
d	1.969 Inch   50 Millimeter
Roller Diameter	3.543 Inch   90 Millimeter
Roller Width	1.181 Inch   30 Millimeter