

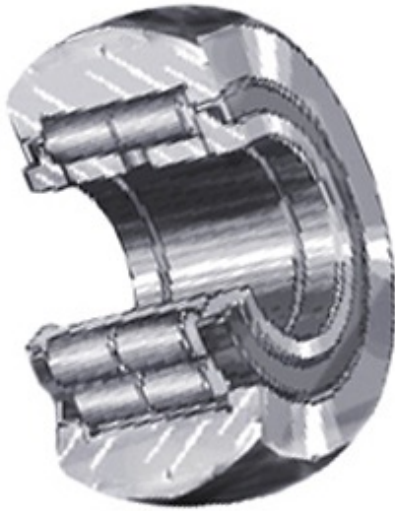

GARLOCK BEARINGS LTD

CONSOLIDATED BEARING NUTR-50110 P/6 Cam Follower and Track Roller - Yoke Type



Bearing No. NUTR-50110 P/6

NUTR-50110 P/6 Bearing 2D drawings and 3D CAD models

Category	Cam Follower and Track Roller - Yoke Type
Inventory	0.0
Manufacturer Name	CONSOLIDATED BEARING
Minimum Buy Quantity	N/A
Weight	1.69
EAN	0644075080569
Product Group	B04144
Roller Surface Profile	Crowned
Profile	Yoke Type
Enclosure	Sealed
Rolling Element	Cylindrical Roller Bearing - Double Row
Relubricatable	Yes
Inch - Metric	Metric
Other Features	Full Complement With Inner Ring ABEC 6 Precision Labyrinth Seal
Long Description	50MM Bore; 110MM Roller Diameter; 30MM Roller Width; Crowned Roller; Yoke Type; Sealed; Cylindrical Roller Bearing - Double Row; Relubricatable
Category	Cam Followers Yoke Type
UNSPSC	31171530
Harmonized Tariff Code	8482.50.00.00



GARLOCK BEARINGS LTD

Noun	Bearing
Keyword String	Cam Follower
Manufacturer URL	http://www.consbrgs.com
Manufacturer Item Number	NUTR-50110 P/6
Weight / LBS	3.726
Roller Width	1.181 Inch 30 Millimeter
Roller Diameter	4.331 Inch 110 Millimeter
d	1.969 Inch 50 Millimeter