

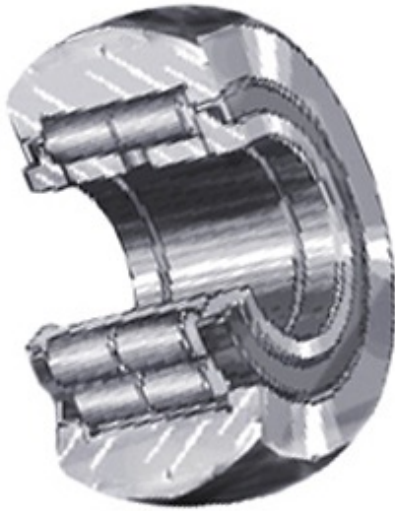

GARLOCK BEARINGS LTD

INA NNTR100X240X105-2ZL Cam Follower and Track Roller - Yoke Type



Bearing No. NNTR100X240X105-2ZL

NNTR100X240X105-2ZL Bearing 2D drawings and 3D CAD models

Category	Cam Follower and Track Roller - Yoke Type
Inventory	0.0
Manufacturer Name	SCHAEFFLER GROUP
Minimum Buy Quantity	N/A
Weight	32.811
Product Group	B04120
Roller Surface Profile	Crowned
Profile	Yoke Type
Enclosure	Sealed
Rolling Element	Cylindrical Roller Bearing-Double Row
Relubricatable	Yes
Inch - Metric	Metric
Other Features	Full Complement Contact Lip Seals
Long Description	100MM Bore; 240MM Roller Diameter; 103MM Roller Width; Crowned Roller Surface Profile; Sealed Enclosure; Cylindrical Roller Bearing-Double Row; Relubricatable
Category	Cam Followers Yoke Type
UNSPSC	31171530
Harmonized Tariff Code	8482.50.00.00
Noun	Bearing
Keyword String	Cam Follower



GARLOCK BEARINGS LTD

Manufacturer URL	http://www.ina.com
Manufacturer Item Number	NNTR100X240X1052ZL
Weight / LBS	61.7
d	3.937 Inch 100 Millimeter
Roller Width	4.055 Inch 103 Millimeter
Roller Diameter	9.449 Inch 240 Millimeter