

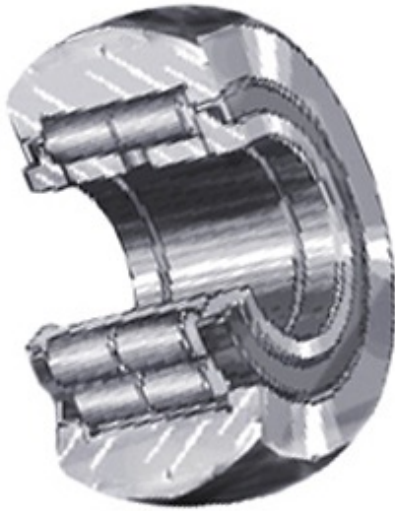

GARLOCK BEARINGS LTD

INA NNTR110X260X115-2ZL Cam Follower and Track Roller - Yoke Type



Bearing No. NNTR110X260X115-2ZL

NNTR110X260X115-2ZL Bearing 2D drawings and 3D CAD models

Category	Cam Follower and Track Roller - Yoke Type
Inventory	0.0
Manufacturer Name	SCHAEFFLER GROUP
Minimum Buy Quantity	N/A
Weight	42.63
EAN	4012802174465
Product Group	B04120
Roller Surface Profile	Crowned
Profile	Yoke Type
Enclosure	Sealed
Rolling Element	Cylindrical Roller Bearing-Double Row
Relubricatable	Yes
Inch - Metric	Metric
Other Features	Full Complement Contact Lip Seals
Long Description	110MM Bore; 260MM Roller Diameter; 113MM Roller Width; Crowned Roller Surface Profile; Sealed Enclosure; Cylindrical Roller Bearing-Double Row; Relubricatable
Category	Cam Followers Yoke Type
UNSPSC	31171530
Harmonized Tariff Code	8482.50.00.00
Noun	Bearing



GARLOCK BEARINGS LTD

Keyword String	Cam Follower
Manufacturer URL	http://www.ina.com
Manufacturer Item Number	NNTR110X260X1152ZL
Weight / LBS	78.5
Roller Width	4.449 Inch 113 Millimeter
Roller Diameter	10.236 Inch 260 Millimeter
d	4.331 Inch 110 Millimeter