

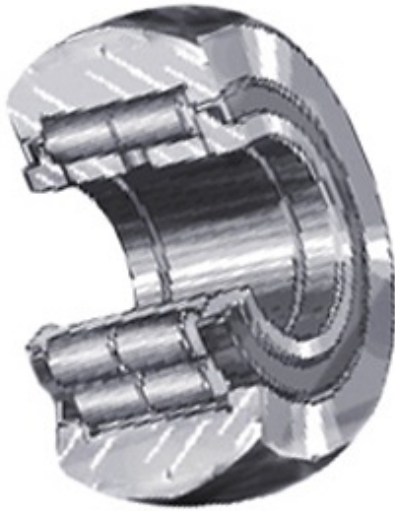

GARLOCK BEARINGS LTD

INA NUTR1542 Cam Follower and Track Roller - Yoke Type



Bearing No. NUTR1542

NUTR1542 Bearing 2D drawings and 3D CAD models

Category	Cam Follower and Track Roller - Yoke Type
Inventory	0.0
Manufacturer Name	SCHAEFFLER GROUP
Minimum Buy Quantity	N/A
Weight	0.16
EAN	4012801180412
Product Group	B04120
Roller Surface Profile	Crowned
Profile	Yoke Type
Enclosure	Sealed
Rolling Element	Cylindrical Roller Bearing - Double Row
Relubricatable	Yes
Inch - Metric	Metric
Other Features	Full Complement With Inner Ring Labyrinth Seal
Long Description	15MM Bore; 42MM Roller Diameter; 18MM Roller Width; Crowned Roller; Yoke Type; Sealed; Cylindrical Roller Bearing - Double Row; Relubricatable
Category	Cam Followers Yoke Type
UNSPSC	31171530
Harmonized Tariff Code	8482.50.00.00
Noun	Bearing
Keyword String	Cam Follower



GARLOCK BEARINGS LTD

Manufacturer URL	http://www.ina.com
Manufacturer Item Number	NUTR1542
Weight / LBS	0.348
Roller Width	0.709 Inch 18 Millimeter
d	0.591 Inch 15 Millimeter
Roller Diameter	1.654 Inch 42 Millimeter